

Midfield Satellite Project (MSC) - Taxiway 'S' Partial Closure and Vehicle Service Road (VSR) Changes

The Midfield Satellite Concourse (MSC) project has moved into the next phase of construction to complete the passenger and utility tunnels between TBIT and the MSC. This phase of the project includes the opening of the northern section of Taxiway T, closing a portion of Taxiway S, and several adjustments to the VSRs located west of TBIT. Additionally, access to Gates 130, 134A, and 148 has been modified and a new connector Taxiway (T2) has been added between Taxiways S and T.

Effective 6/6/18, Taxiway S between Taxiway T1 and T2 will be closed for approximately 16 months. During this time, VSR S will be closed between Gates 134 and 130. The new VSR T, located west of VSR S will be available for north/south transitions and can be accessed from VSR S using the two new east/west crossings.

Please see diagrams below for reference.

Thank you for your support.

For questions or comments regarding this advisory please contact Airside Manager, Jeff Mort, Jmort@lawa.org.

Issue Date: May 8th, 2018

Subject: Midfield Satellite Project (MSC) - Taxiway S Partial Closure and Vehicle Service Road (VSR) Changes

*The LAX Operations Advisory will be posted on LAWA's Airport Operations website and can be retrieved at <http://www.lawa.org/airops.aspx>



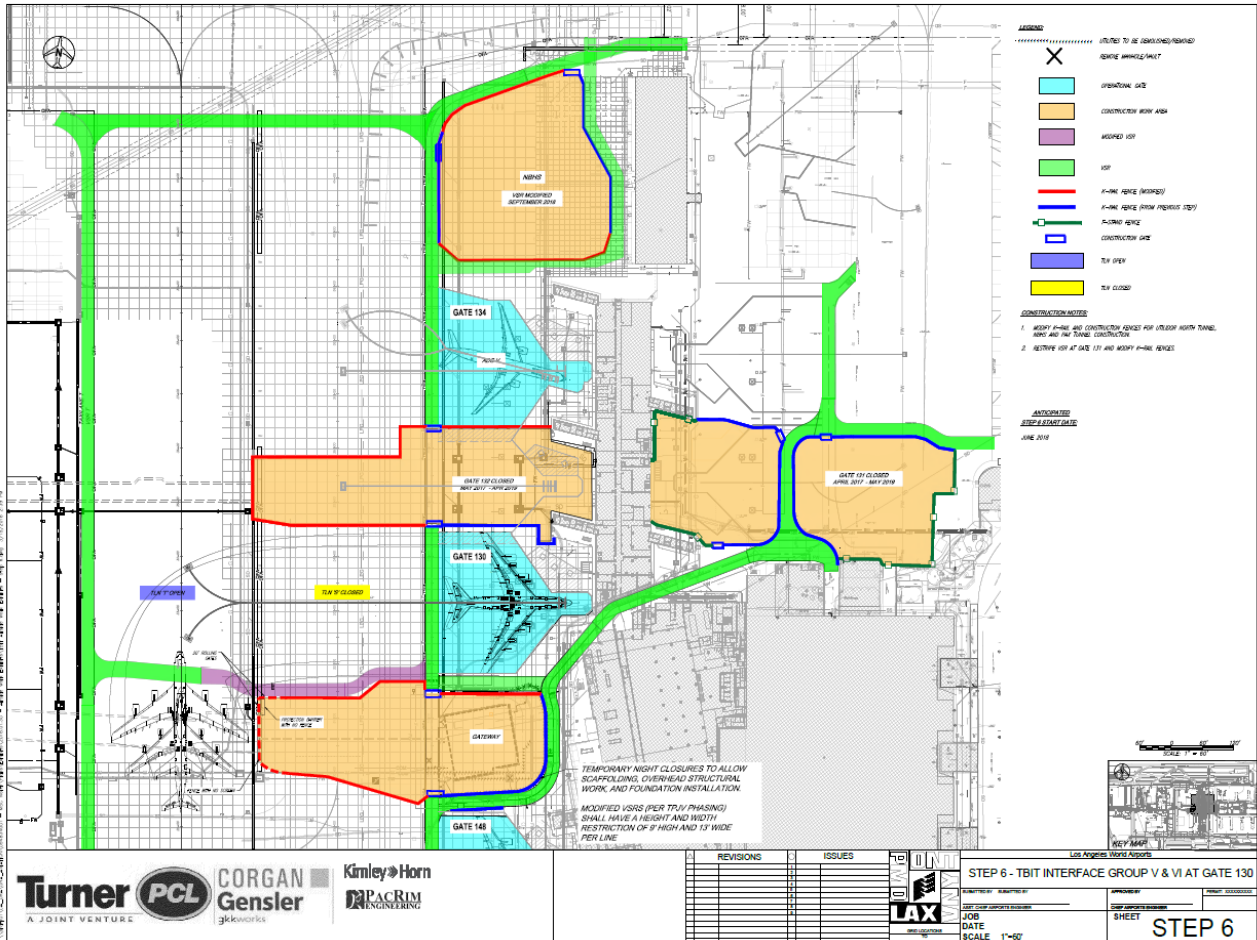

Issue Date: May 8th, 2018

Subject: Midfield Satellite Project (MSC) - Taxiway S Partial Closure and Vehicle Service Road (VSR) Changes

*The LAX Operations Advisory will be posted on LAWA's Airport Operations website and can be retrieved at <http://www.lawa.org/airops.aspx>



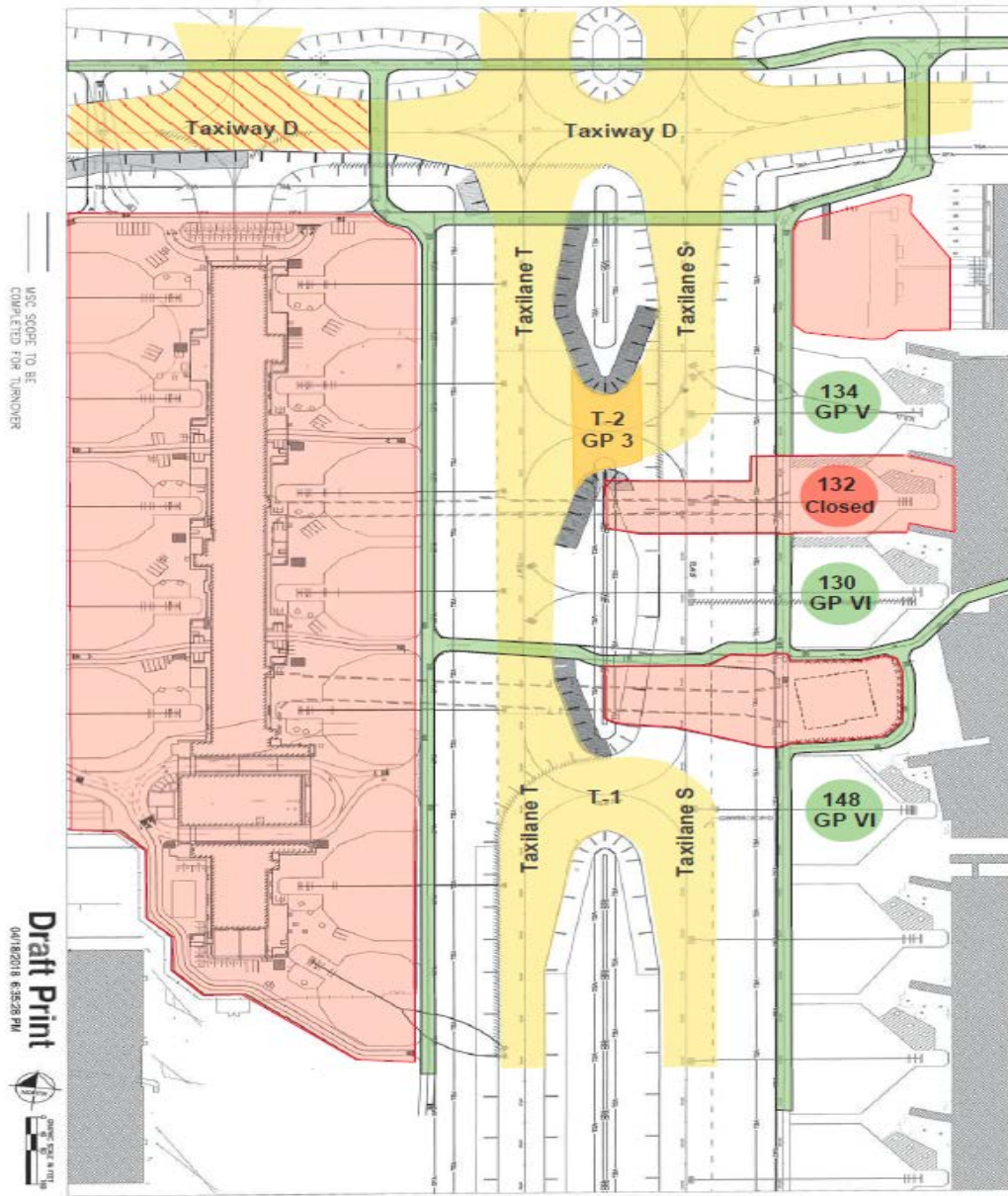

Issue Date: May 8th, 2018

Subject: Midfield Satellite Project (MSC) - Taxiway S Partial Closure and Vehicle Service Road (VSR) Changes

*The LAX Operations Advisory will be posted on LAWA's Airport Operations website and can be retrieved at <http://www.lawa.org/airops.aspx>

