

Taxiway A Shoulder Repaving – Daily Taxiway Closures Impacting Access to Imperial Cargo Complex

Taxiway A will be closed daily for shoulder asphalt repaving and markings restoration for four consecutive days. The Imperial Cargo Complex (ICC) will not be accessible for aircraft movement during the work hours. Please see the closure schedule below and page two exhibit outlining the work area for Phase 3B. Additional closures will be scheduled for a later date to complete the remaining phases of this project.

Closure Schedule:

Phase 3B – Repaving: Taxiway A closed between Taxiway F and Taxilane A1. Taxiway F remains open.

- February 18, 2020 – February 20, 2020 daily, 0700 – 1500L.

Phase 3B – Markings restoration: Taxiway A closed between Taxilane A1 and Taxilane A3, Taxilane A2 closed, and Taxiway F closed south of Runway 25L.

- February 21, 2020, 0700-1500L.

A Notice to Airmen (NOTAM) will be issued 72 hours prior to the scheduled closures. Please plan your flight operations accordingly. For current airfield operating conditions please check NOTAMs at <https://pilotweb.nas.faa.gov>. Thank you for your support.

For questions or comments regarding this advisory, please contact Airside Manager, Jeff Mort, Jmort@lawa.org.

Issue Date: February 06, 2020

Subject: Taxiway A Shoulder Repaving – Daily Taxiway Closures Impacting Access to Imperial Cargo Complex

*The LAX Operations Advisory will be posted on LAWA's Airport Operations web site and can be retrieved at <http://www.lawa.org/aiops.aspx>



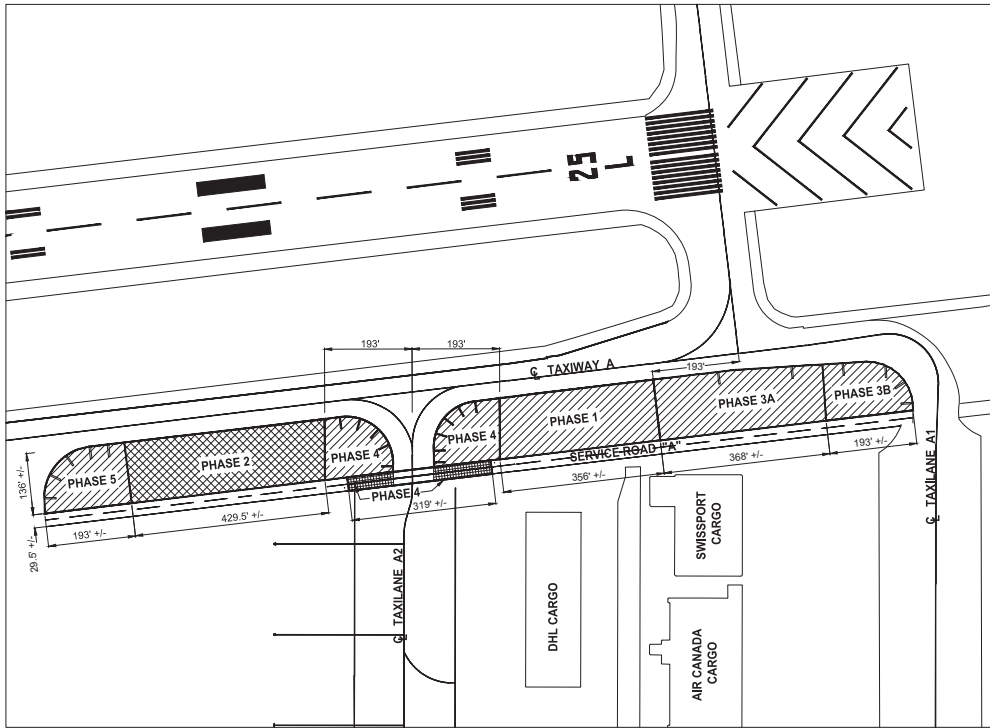

SITE PLAN
SCALE: 1"=100'-0"

INDEX OF DRAWINGS		
SHEET NUMBER	SHEET TITLE	SHEET DESCRIPTION
1	G-1	COVER SHEET
2	C-1	SITE PLAN AND DRAWING INDEX
3	C-2	PHASE 1 - PAVEMENT REHABILITATION PLAN
4	C-3	PHASE 2 - PAVEMENT REHABILITATION PLAN
5	C-4	PHASE 3A - PAVEMENT REHABILITATION PLAN
6	C-5	PHASE 3B - PAVEMENT REHABILITATION PLAN
7	C-6	PHASE 4 - PAVEMENT REHABILITATION PLAN
8	C-7	PHASE 5 - PAVEMENT REHABILITATION PLAN
9	C-8	PHASE 1 - PAVEMENT MARKING PLAN
10	C-9	PHASE 2 - PAVEMENT MARKING PLAN
11	C-10	PHASE 3A - PAVEMENT MARKING PLAN
12	C-11	PHASE 3B - PAVEMENT MARKING PLAN
13	C-12	PHASE 4 - PAVEMENT MARKING PLAN
14	C-13	PHASE 5 - PAVEMENT MARKING PLAN
15	C-14	PAVEMENT MARKING DETAIL
16	C-15	PHASE 4 - TEMPORARY AIRCRAFT ROUTE PLAN
17	C-16	PHASE 5 - TEMPORARY AIRCRAFT ROUTE PLAN

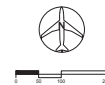

Los Angeles World Airports

LAX **LAVNY** **PMD**

SHOULDER & SURFACE RD REPAIR AT TWY "A" & SERVICE RD "A"
SITE PLAN & DRAWING INDEX
 LOS ANGELES INTERNATIONAL AIRPORT

APPROVED BY: [Signature]

DATE	DESIGN	PLAN BY NUMBER	SHEET
12-19-2018	EH	02 OF XX	C-1
AS NOTED	DATE	DATE	DATE
	12-19-2018		
FILE NAME	20180054		

20180054-02