

Taxiway A Shoulder & Vehicle Service Road A Repaving – Daily Taxiway Closures

Taxiway A will be closed daily for shoulder asphalt repaving and markings restoration for two consecutive weeks, Monday through Thursday 0700-1530L. The remaining phases for this project will impact tenant aircraft access at Taxiway A2 and Taxiway A3. Vehicle Service Road (VSR) A will be repaved at Taxiway A2 intersection one week prior to the taxiway shoulder construction. The Imperial Cargo Complex (ICC) will remain accessible for all aircraft except ADG VI during the work hours. Please see the remaining project scope and schedule details below.

Project Scope & Schedule:

Phase 4 – Repaving & Markings Restoration: VSR A will be repaved at the Taxiway A2 apron intersection. VSR A will remain open for both eastbound and westbound traffic with traffic control. Taxiway A2 apron will be closed during the construction work hours. Taxiway A will remain open for all aircraft. No impacts to ICC during this phase.

- March 09, 2020 – March 12, 2020 daily, 0700 – 1530L.

Phase 5 – Repaving & Markings Restoration: Taxiway A3 shoulder will be repaved on the southeast side. Taxiway A will be closed between Taxiway A2 and Taxiway A3, and Taxiway A3 apron will be closed. Taxiway A2 apron will remain accessible. ICC will remain accessible for all aircraft except ADG VI. Alternate ADG VI cargo parking will be available during the closure hours.

- March 16, 2020 – March 19, 2020 daily, 0700 – 1530L.

Phase 6 – Repaving & Markings Restoration: Taxiway A2 shoulder will be repaved on the southwest side. Taxiway A will be closed between Taxiway F and Taxiway A3, and Taxiway A2 apron will be closed. Taxiway A3 apron will remain accessible. ICC will remain accessible for all aircraft except ADG VI. Alternate ADG VI cargo parking will be available during the closure hours.

- March 23, 2020 – March 26, 2020 daily, 0700 – 1530L.

A Notice to Airmen (NOTAM) will be issued 72 hours prior to the scheduled closures. Please plan your flight operations accordingly. For current airfield operating conditions please check NOTAMs at <https://notams.aim.faa.gov/notamSearch/disclaimer.html>. Thank you for your support.

For questions or comments regarding this advisory please contact Airside Manager, Jeff Mort, Jmort@lawa.org.

Issue Date: February 28, 2020

Subject: Taxiway A Shoulder Repaving – Daily Taxiway Closures

*The LAX Operations Advisory will be posted on LAWA's Airport Operations web site and can be retrieved at <http://www.lawa.org/airops.aspx>



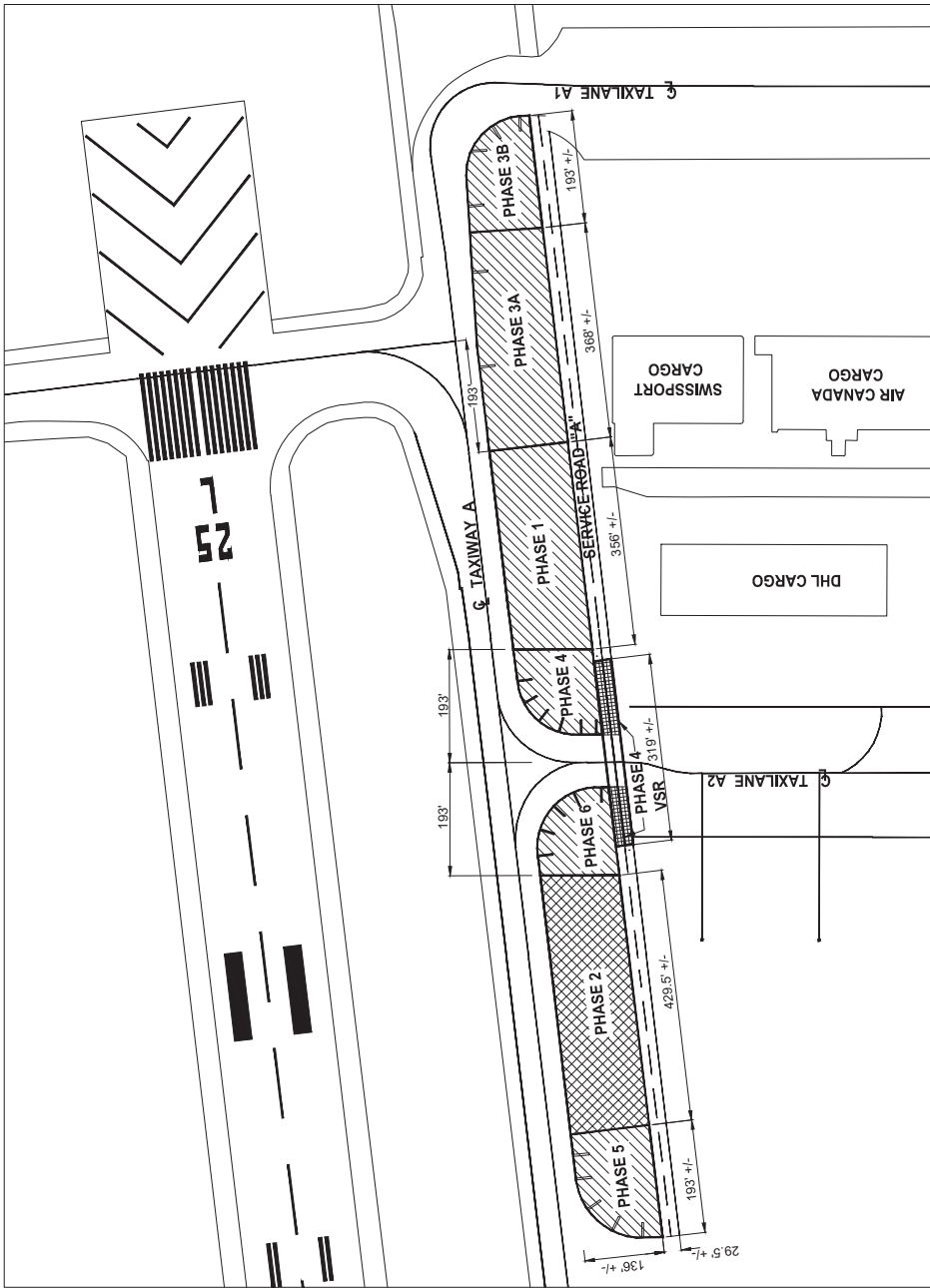

INDEX OF DRAWINGS	
SHEET NUMBER	SHEET TITLE
1	G-1 COVER SHEET
2	C-1 SITE PLAN AND DRAWING INDEX
3	C-2 PHASE 1 - PAVEMENT REHABILITATION PLAN
4	C-3 PHASE 2 - PAVEMENT REHABILITATION PLAN
5	C-4 PHASE 3A - PAVEMENT REHABILITATION PLAN
6	C-5 PHASE 3B - PAVEMENT REHABILITATION PLAN
7	C-6 PHASE 4 - PAVEMENT REHABILITATION PLAN
8	C-7 PHASE 5 - PAVEMENT REHABILITATION PLAN
9	C-8 PHASE 1 - PAVEMENT MARKING PLAN
10	C-9 PHASE 2 - PAVEMENT MARKING PLAN
11	C-10 PHASE 3A - PAVEMENT MARKING PLAN
12	C-11 PHASE 3B - PAVEMENT MARKING PLAN
13	C-12 PHASE 4 - PAVEMENT MARKING PLAN
14	C-13 PHASE 5 - PAVEMENT MARKING PLAN
15	C-14 PAVEMENT MARKING DETAIL
16	C-15 PHASE 4 - TEMPORARY AIRCRAFT ROUTE PLAN
17	C-16 PHASE 5 - TEMPORARY AIRCRAFT ROUTE PLAN

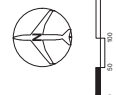

SITE PLAN
SCALE: 1"=100'-0"

Los Angeles World Airports

LAX **VNY** **PMD**

SHOULDER & SURFACE RD REPAIR AT TAXIWAY A & SERVICE ROAD "A"
SITE PLAN & DRAWING INDEX

PREPARED BY: LOS ANGELES INTERNATIONAL AIRPORT

DESIGNED BY	DATE	SCALE	SHEET NO.
DRWN	12/18/2018	1"=100'-0"	17 OF 22

20180054-02