

Vehicle Service Road Charlie Repaving Project – VSR Detours and Associated Taxiway Closures Required

Vehicle Service Road (VSR) Charlie will be closed between Taxiway K and Taxiway R for a repaving project starting April 28, 2020 through April 30, 2020. The closure hours will be 0400-1400L daily April 28 and April 29 for paving activities, and 0001-0800L April 30 for markings restoration. Several taxiways will be closed to support this project. VSR Charlie traffic will be detoured onto the closed portion of Taxiway B around the repaving work area. Please see page two for an exhibit depicting the project limits and VSR detour plan.

Taxiway Closures:

- Taxiway B between Taxiway K and Taxiway R closed daily 4/28/2020 through 4/29/2020 (0400-1400L), and 4/30/2020 (0001-0800L).
- Taxiway L between Runway 25R and Taxiway C closed daily 4/28/2020 through 4/29/2020 (0400-1400L), and 4/30/2020 (0001-0800L).
- Taxiway B13 between Taxiway B and Taxiway C closed daily 4/28/2020 through 4/29/2020 (0400-1400L), and 4/30/2020 (0001-0800L).

A Notice to Airmen (NOTAM) will be issued 72 hours prior to the scheduled closures. Please plan your flight operations accordingly. For current airfield operating conditions please check NOTAMs at <https://notams.aim.faa.gov/notamSearch/disclaimer.html>. Thank you for your support.

For questions or comments regarding this advisory please contact Airside Manager, Jeff Mort, Jmort@lawa.org.

Issue Date: April 24, 2020**Subject: Vehicle Service Road Charlie Repaving Project – VSR Detours and Associated Taxiway Closures Required**

*The LAX Operations Advisory will be posted on LAWA's Airport Operations web site and can be retrieved at <http://www.lawa.org/airops.aspx>



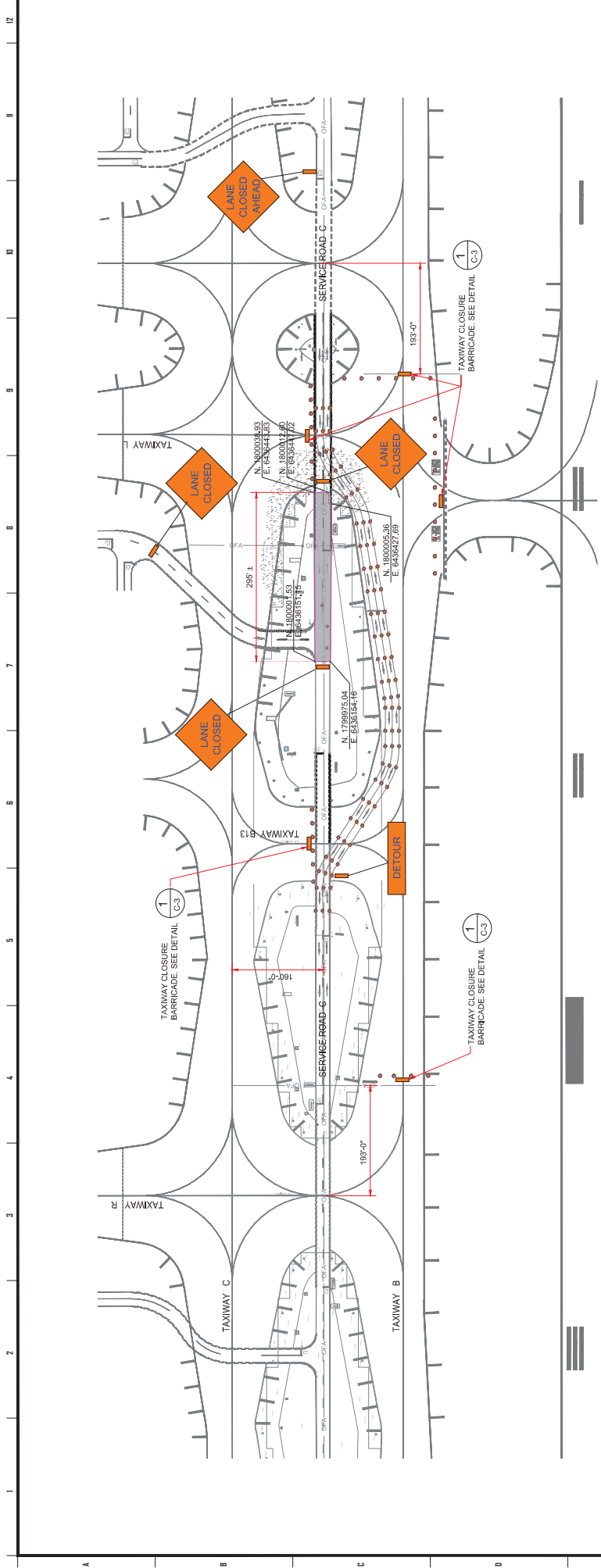

**PAVEMENT REHABILITATION
TRAFFIC CONTROL PLAN P - PHASE II**
SCALE: 1"=80'-0"

AREA:
6,600 SQ FT ±

- SCOPE OF WORK:**
- MILL AND OVERLAY 3-INCH OF AC PAVEMENT (R401 MIX)
 - RE-STRIP PAVEMENT MARKINGS PER PAVEMENT MARKING PLAN
 - PROTECT ALL EXISTING UTILITIES SUCH AS DRAINAGE, POWER, MANHOLE, ETC., DURING CONSTRUCTION

- TRAFFIC CONTROL NOTES:**
- BOTH LANES TO BE CLOSED FOR CONSTRUCTION
 - TRAFFIC TO BE DETOURED PER PLAN

- LEGEND:**
- EXISTING CONCRETE PAVEMENT
 - MILL AND OVERLAY 3-INCH OF AC PAVEMENT
 - DIRECTION OF TRAFFIC DETOUR
 - TRAFFIC DELINEATORS TO BE PLACED AT 40 FEET SPACING
 - SIGN PER PLAN

DRAFT

Los Angeles World Airports
VSR C BET. TWY R & TWY L - PAVEMENT REHABILITATION AND TRAFFIC CONTROL PLAN - PHASE II
LOS ANGELES INTERNATIONAL AIRPORT

SUBMITTED BY	ASSISTANT CHIEF ENGINEER	CHIEF ENGINEER	CHIEF AIRPORT ENGINEER
DRAMA	PLAN NO. 20200504-C1	DATE	DATE
BY	DATE	DATE	DATE
AS SHOWN	DATE	DATE	DATE
FILE NAME	DATE	DATE	DATE

20200504